

Loose Pin (Machinel Type)

Specifications

- ❑ 材質: 黃銅、磷青銅、鍍錫銅、紅銅(或依客戶要求)
 - ❑ 電鍍方式: 鍍金、鍍錫、鍍錫鉛... (鍍層厚度或依客戶要求作調整)
 - ❑ 系列: 方Pin、圓Pin
 - ❑ 型態: 車型Pin
 - ❑ 線徑: 0.5mm ~ 1.2mm
 - ❑ 總長度: 10.0mm ~ 40.0mm
 - ❑ 圖中各尺寸可依客戶的要求作隨意更改,倒角可做切支或任一R角
 - ❑ 可兩面或四面打點
-
- ❑ Material: Brass、Phosphor Bronze、Tinned Copper、Copper (According to customers requirement)
 - ❑ Plating: Gold、Tin、Lead Tin ... (The plating model and plating thickness are adjustable as the customer' request)
 - ❑ Series: Square Pin、Round Pin
 - ❑ Type: Machinel Type
 - ❑ Diameter: 0.5mm ~ 1.2mm
 - ❑ Length: 10.0mm ~ 40.0mm
 - ❑ Sizes in the diagram may be modified according to customers requirement, Chamfer angle can be sheared without any processing or to R angle.
 - ❑ The sides or four sides can be dotted.

Drawing

A Type

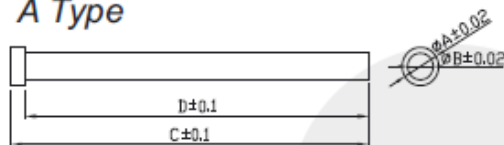

D Type

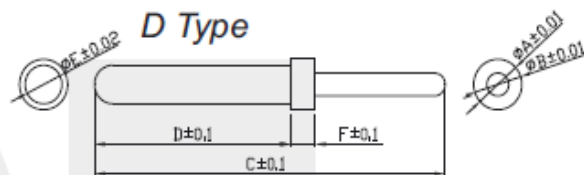

B Type

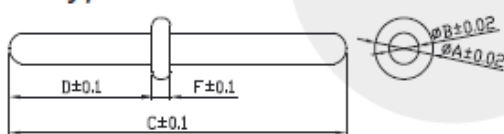

E Type

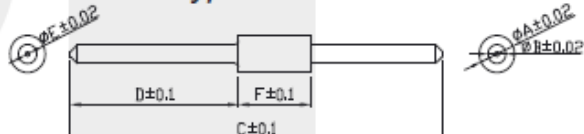

C Type

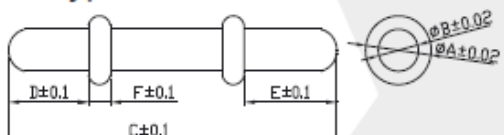

F Type

